

67.5 - 75W Dual Output Quarter Brick Converter

Features

- ◆ Standard Quarter Brick Footprint
- ◆ 36-75VDC Input
- ◆ 2.5/1.8V 24A - 5.0/3.3V 15A Nominal Outputs
- ◆ Through Hole Mounting
- ◆ Low 12.7mm Profile
- ◆ 1500VDC Basic Isolation
- ◆ Independent output trim
- ◆ Constant switching frequency
- ◆ Baseplate

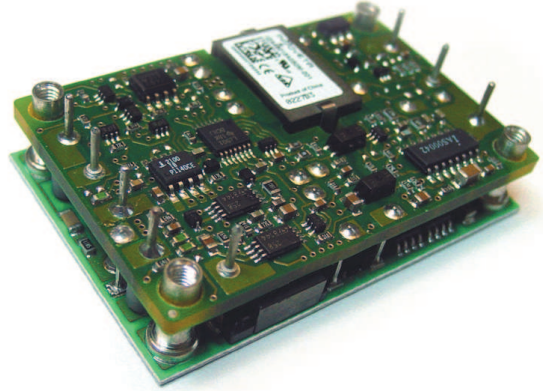

Specifications

Model		iQA48		
Nominal Output Voltage	VDC	3.3 / 1.8	3.3 / 2.5	5.0 / 3.3
Input Voltage Range	VDC	36 - 75		
Input Current (max)	A	3		
Output Voltage Tolerance	VDC	3.20 - 3.40	3.20 - 3.40	4.85 - 5.15
		1.74 - 1.86	2.42 - 2.58	3.20 - 3.40
Ripple & Noise (max) (pk to pk)	mV	80 / 70	80 / 70	40 / 40
Line Regulation (max)	mV	5	5	2
Load Regulation (max)	mV	15		5
Overload Protection (typ)	%	Inception - 120% of rated output; Short circuit - auto recovery hiccup		
Overvoltage Protection	-	Yes		
Remote Sense	-	N/A		
Remote On / Off	-	Positive or Negative Logic available, see Feature Set		
Temperature (operating)	°C	-40 to 105		-40 to 110
Temperature (storage)	°C	-55 to 125		
Humidity (operating)	-	20-95% RH Non condensing		
Humidity (storage)	-	10-95% RH Non condensing		
Cooling	-	Convection or forced air		
Isolation Voltage	VDC	1500V Input to output & baseplate, 500V Output to baseplate		
Vibration (non operating)	-	5 to 50Hz @ 0.5g (4.9m/s ²), and 50 to 500Hz @ 1.5g (14.7m/s ²) per Bellcore TR-EOP-000063-5.4.4		
Shock	-	196.1m/s ²		
Safety Agency Approvals	-	UL60950 (US and Canada), VDE0805 (IEC60950), CB scheme (IEC60950), CE Mark (LVD)		
Weight (max)	g	47		
Size	mm	58.4 x 38.1 x 12.7		
Warranty	-	3 Years		

Notes: See website for detailed specifications

OBSOLETE

Model Selector

Model	Voltage (V)	Adjust Range (V)	Max. Curr. (A)	Max. Output Power (W)	Efficiency at Full Load (%)
iQA48024A033M-103-R	3.3 / 1.8	N/A	15/15 (24 total)	67.5	85
iQA48024A033M-001-R	3.3 / 2.5	1.5-3.63 / 1.0-3.3	15/15 (24 total)	72	85
iQA48015A050M-001-R	5.0 / 3.3	1.5-5.5	15/15 (15 total)	75	87

Recommended Footprint (Top View)

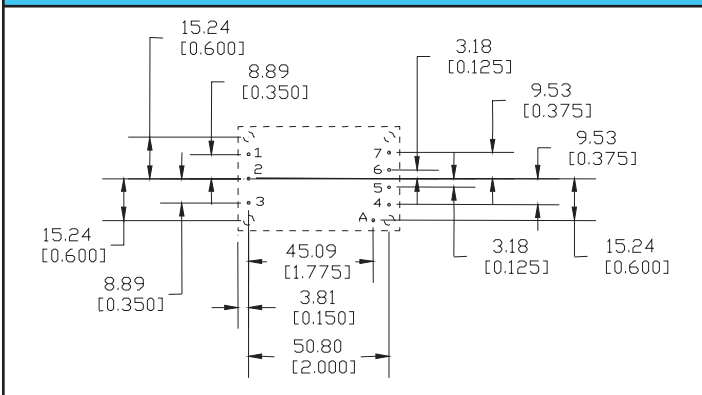

For Additional Information, please visit us.tdk-lambda.com/lp/products/iqa-series.htm



Feature Set

Feature Set	Logic On / Off	Pin Length	Trim
00	Positive	0.145"	Dual independent pins
01*	Negative	0.145"	Dual independent pins
02	Positive	0.145"	Single tracking pin
03	Negative	0.145"	Single tracking pin
04	Positive	0.110"	Dual independent pins
05	Negative	0.110"	Dual independent pins
06	Positive	0.110"	Single tracking pin
07	Negative	0.110"	Single tracking pin

* Preferred feature set
Model Number Example: iQA48015A050M-001-R

PIN Assignments

PIN	Function
1	Vin (+)
2	On / Off
3	Vin (-)
4	Vo2 (+)
5	Output RTN
6	Vo1 Trim (optional: single tracking trim pin)
7	Vo1 (+)
A	Vo2 Trim (optional: omit for single trim pin option)

Other DC-DC Products

CC-E	1.5-12W, 1 to 2 Outputs, 5 to 48VDC Input
PX	10-40W, 1 to 3 Outputs, 12 to 48VDC Input
iPB	15-35W, 1.5-5V Output, 36-75VDC Input, Pico Brick
iSA	30-78W, 1.2-12V Output, 36-75VDC Input, Sixteenth Bricks
iEA	30-78W, 1.2-28V Output, 36-75VDC Input, Eighth Brick DC-DC
PAE50/100	36-100W, 1.9-5V Output, 36-75VDC Input, Eighth Brick DC-DC
iEB	150W, 12V Output, 42-56V Input, Eighth Brick Intermediate Bus DC-DC
iQD	300W, 12V Output, 42-53VDC Input, Quarter Brick Intermediate Bus DC-DC
iQB, iQM, iQN, iQP	30-300W, 1.2-12V Output, 24 to 48VDC Input, Quarter Brick DC-DC
PAH300/350	300-350W, 12 to 28V Output, 36-75VDC Input, Half Brick DC-DC
PAF	400-700W, 1.8 to 48V output, 24 to 400VDC Input, Full Brick DC-DC
FPS	1kW to 3kW, 24 to 48V Output, AC-DC Front Ends
iAA, iBC, PL	Non Isolated DC-DC Converters

OBSOLETE